



深圳市欧卡达科技有限公司

Shenzhen OKD Technology Co.,Ltd

Work Principle

proximity switch connected by a reed pipe warp, setting package is made when the magnetic body close, cause the switching action, usually used as a position sensor.

Feature

- ◆Small size, easy to install, reliable performance, stainless steel, wear-resistant and high temperature.
- ◆No standby power consumption, seal installation, stable, when the optical and other types of sensors due to the poor conditions and can not work properly, the magnetic sensor can still be used normally, installation is simple and easy to adjust.

Applications

Measuring instruments, office automation equipment, household goods, security and safety equipment, transportation equipment.

OKD-GPS30

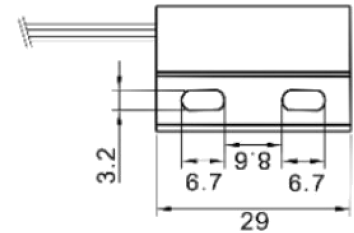

Power (W)	Voltage (VDC)	Current (A)	Pressure (VDC)	Switch Type	Package (Sets)
10	100	0.5	200	N.C /N.O	20
Working distance			15--20mm/20--25mm		
Case Material			Imports of high-quality ABS		
Fixation			Screw mount		

Shenzhen OKD Tech Co.,Ltd

Add:Room 2009 Dingcheng international building Zhonghang Road Futian District Shenzhen
 Tel:86-755-83661511
 Fax:86-755-83559755
 Email:szsokd@sina.com
 Site:http://www.sz-okd.com
 QQ:137030453